



CX-500HQ / PS-510M

Hu Qin Microphone Set / Power Supply with Personal Mix

The CX-500HQ consists of two CX-500CI microphones and one PS-510M power mixer. This microphone set is designed to pick up both sides of the Chinese folk instrument Hu Qin or other similar string instruments. It reproduces crystal clear strings and the warm harmonic. The bundled PS-510M helps to find the best mix of two microphones.

- Omni-directional Capsule
- Smooth Frequency Response
- Adjustable Holder
- Terminated with 4 pin mini XLR for easy wireless application.
- PS-510M is built with earphone output for musician to monitor a preferred mix of two microphone signals before goes to PA.
- Cable MX2X-50 help the whole set goes wireless.

Contain

- 1 CX-500CI Condenser Microphone x2
- 2 PS-510M Power Supply x1
- 3 Windscreen x2
- 4 Velcro straps x2 (short: 45cm ; long: 65cm)
- 5 Cable: MX2X-50 x1

Specifications

CX-500HQ	
Type	Omni-directional Condenser
Frequency Response	20~20,000 Hz
Sensitivity (at 1,000 Hz)	$-58 \pm 3 \text{dB} (1.25 \text{mV}) * 0 \text{dB} = 1 \text{V} / \mu \text{bar}$
Impedance	1.5k Ω
Max.SPL for 1% T.H.D.	130dB
Signal-To-Noise Ratio	68dB
Output Connector	4P Mini XLR
Power Supply	1-5 VDC
Current Consumption	\varnothing 0.05mA
Weight	37.4 grams (including cable)
Dimensions (mm)	\varnothing 6.4mm * 22.7mm(L)

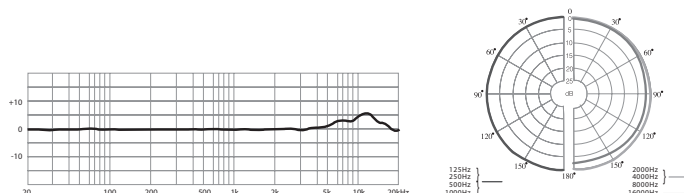
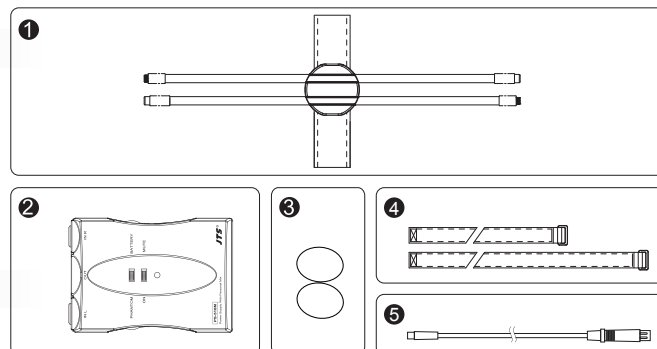

Connect to mixer or wireless transmitter

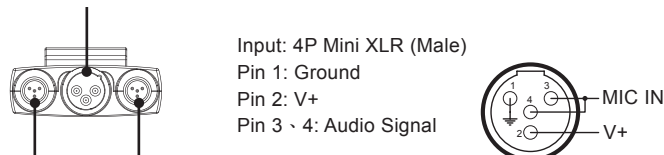

JTS CX-500HQ - Hu Qin Microphone Set Instruction

- 1 Put the strap velcro side facing up and through the CX-500HQ holder. Replace your own velcro strap if you find the length is not proper.
- 2 Place and fit the CX-500HQ holder at the front end of the drum resonator. It is recommended the CX-500HQ holder with strap to be aligned with the upper end edge.
- 3 Place the CX-500CI microphones at both left and right sides of the CX-500HQ holder.
- 4 We recommend CX-500CI microphone distance at 6cm near the membrane, while 8-10cm near the open side of the drum resonator. However, the actual distance depends on the user's preference.

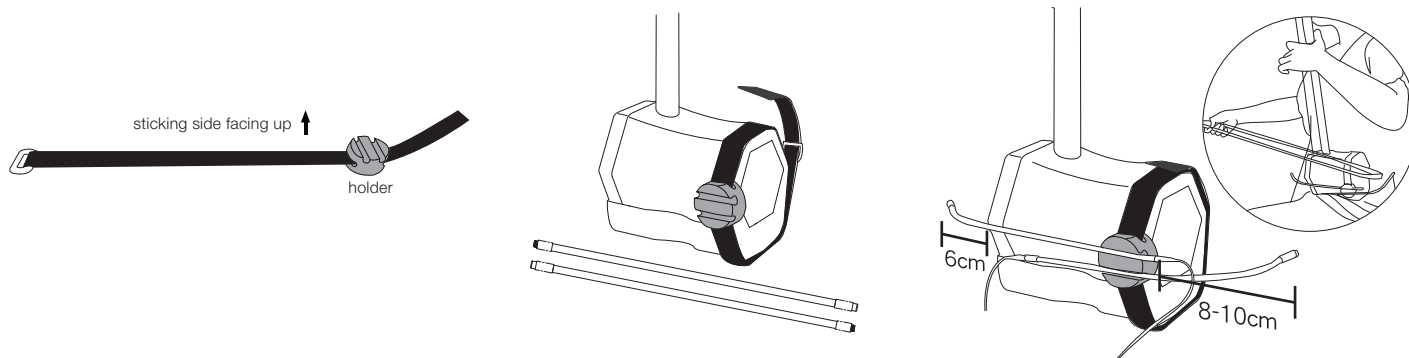

- ⚠ To extend the service life of CX-500CI condenser microphone, make sure the microphone is placed under appropriate temperature and humidity environment.
- ⚠ Please use the JTS original microphone holder and related accessories to ensure the most effective sound quality. Any non-JTS parts may cause damage to the product.



59010-525-02

PS-510M Dual Input Power Supply With Personal Mix

Thank you for choosing JTS PS-510M Dual Of Supply With Personal Mix.

In order to obtain the best efficiency, you are recommended to read this manual before using.

Feature

- PS-510M the Dual input power supply provides 9V(by using a 9V battery) / 12~48 V(by using power from the mixer) phantom power to condenser microphones.
- Two mini XLR (M) inputs.
- Separate volume controls can be set independently, which make PS-510M work as a personal mixer.
- Reliable plastic belt clip makes it easy to attach PS-510M to a belt.
- Earphone output for musician to monitor a preferred mix.

Parts Identification

- 1 Case
- 2 Audio Input Socket (4P Mini XLR, Male)
- 3 Audio Output Socket (3P XLR, Male)
- 4 Volume Control
- 5 Power On / OFF / Low Batt. Indicator
- 6 Phantom / Batt. Switch
- 7 On / Mute Switch
- 8 Belt Clip
- 9 Battery Compartment
- 10 Output MIC. / Line Level Switch
- 11 Earphone Jack (3.5mm dummy stereo)
- 12 Earphone Volume Control

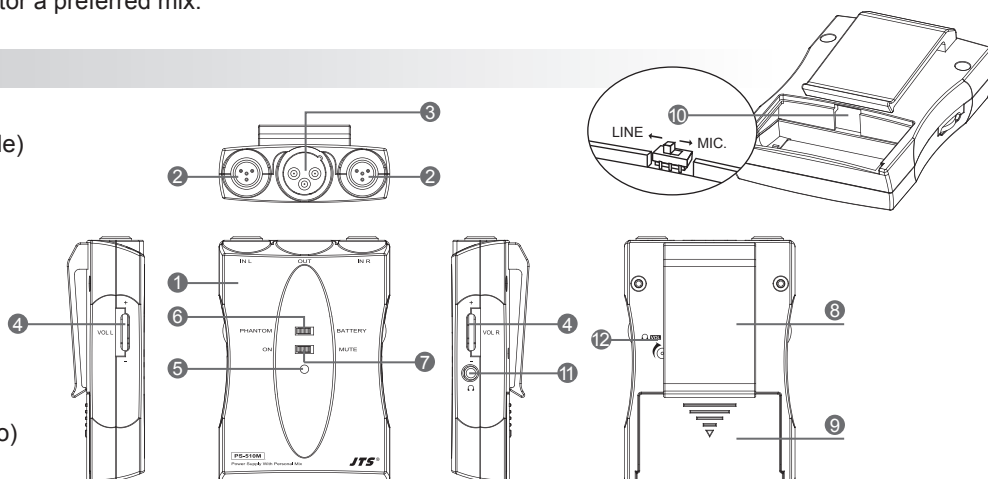

Use Instruction

Installation (Figure 1)

1. Connect one or two microphones to the XLR inputs. (IN L / IN R)
2. Connect the XLR output to a mixer by using an audio cable.
3. Switch MIC. / LINE switch to match the output level to the input of the connected mixer.

Operation

1. Insert one piece of 9V battery to the battery compartment.
2. Switch phantom / Batt. to power the PS-510M. (Figure 2)
3. Switch On / Mute: On: Audio output enabled, earphone output disabled, audio output disabled.
Mute: earphone output enabled.
4. Adjust the volumes of the right and left inputs to have a preferred mix. (Figure 3)

LED Indicator

LED indicator shows the On / OFF / Low Batt. status. (Figure 2)

When the LED lights up GREEN, the PS-510M is ON and the power supply is normal.

Low Batt. : LED RED

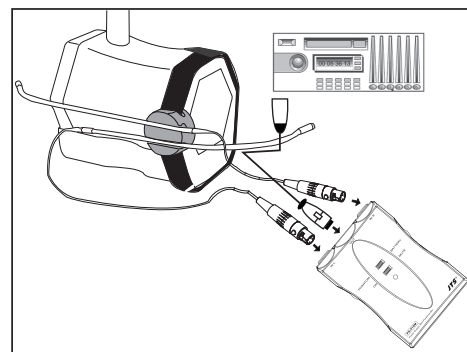

Figure 1

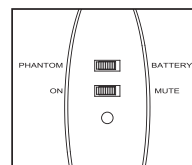

Figure 2

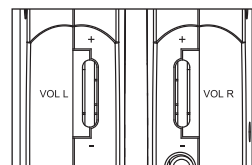
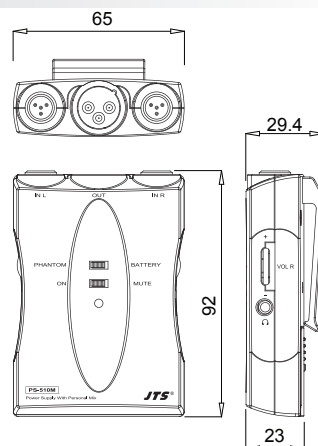

Figure 3

Specification

PS-510M	
Frequency Response	20~20,000 Hz
Power Supply	Batt. Power 9V / 12~48V Phantom Power
Current Consumption	max. 20 mA
Battery	max. 80mA with Headphone (16Ω/32Ω)
Input Impedance	5 k Ω
Output Impedance	470 Ω balanced
Input Connector	4P Mini XLR(M) (2 channels)
Output Connector	3P XLR(M)
Dimension(m/m)	92mm(W)* 23mm(H)* 65mm(D)



Note: The earphone output will work only under battery power.